

PRODUCT DATA SHEET – M

Section 1. PRODUCT DESCRIPTION

TOGGLE ANCHOR – M

Toggle anchor is made of steel with zinc chromate coating. It is used for lightweight fixing of interior finish products in cavity materials and plasterboards. The crosspiece forms a large support surface which ensures a very strong and secure fixing.

Types of substrates on which anchor M can be installed:

- Clay brick and sand-lime brick
- Hollow clay brick
- Plasterboard



Section 2. METHOD OF INSTALLATION

1. Original anchors delivered by the manufacturer can be used only
2. Before installation identify a substrate in which the anchor will be installed and compare loads which the anchor will carry to the resistance values
3. Select adequate anchor length, depending on sum of thickness values of members being fixed
4. Holes in plasterboard should be drilled using drilling bits for timber or steel in order not to damage structure of the board
5. Diameter of drilled holes should match diameter of the anchors used
6. Anchors cannot be installed facing downwards (e.g. in a floor)

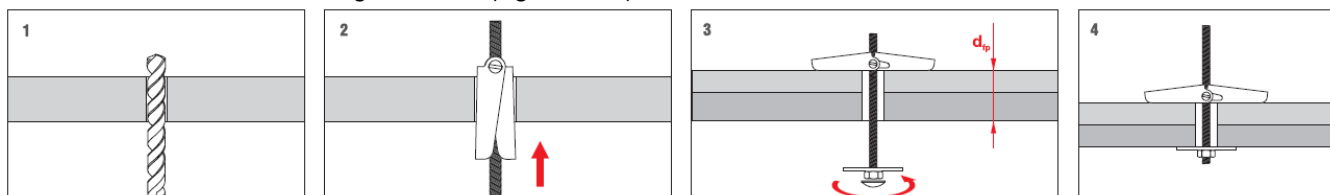

Section 3. TECHNICAL DATA

RESISTANCE	
Product code	Characteristic/design resistance*
	[kN]
M4 x 50	1,08/0,54
M4 x 75	1,08/0,54
M5 x 75	1,45/0,72
M5 x 90	1,45/0,72

*Fastener resistance does not account for base material resistance

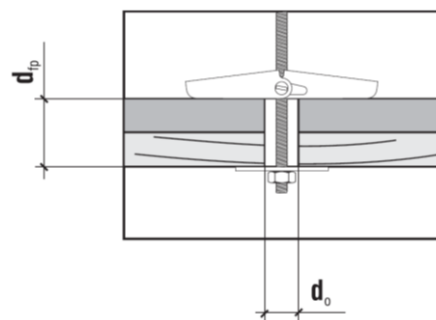
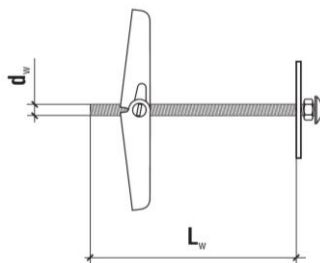

SELECTION TABLE				
Product code	Fastener diameter and length	Hole diameter	Maximum drywall thickness	Number of pieces in a box
	d_w x L_w [mm]	d_0 [mm]	d_fp [mm]	[pcs]
M-04050	M4 x 50	14	20	50
M-04075	M4 x 75	14	42	50
M-05075	M5 x 75	16	42	25
M-05090	M5 x 90	16	57	25

PRODUCT DATA SHEET – M

Section 4. REMARKS

1. All previous versions of this Product Data Sheet shall cease to be valid
2. Data given in this Product Data Sheet is in accordance with current knowledge and published in good faith. KLIMAS Sp. z o.o. is not responsible for correctness and quality of the fixing if recommendations regarding method of use and installation are not followed.